

## South Side Lower Level

- Most flexible large space available
- Macleod Hall can be used as one contiguous space or eight smaller spaces
- Large pre-function space

With its movable walls, Macleod Hall offers the ultimate in flexibility, and can be easily transformed from one room to seven. It can accommodate events for as few as 30 people and as many as 2,100. It can serve as a plenary hall, banquet hall, ballroom and several breakout rooms all in one.

Macleod Hall's abundant pre-function space is equally versatile, and can be used for registration, buffet service meals, refreshment breaks, receptions, or a welcoming bar area.

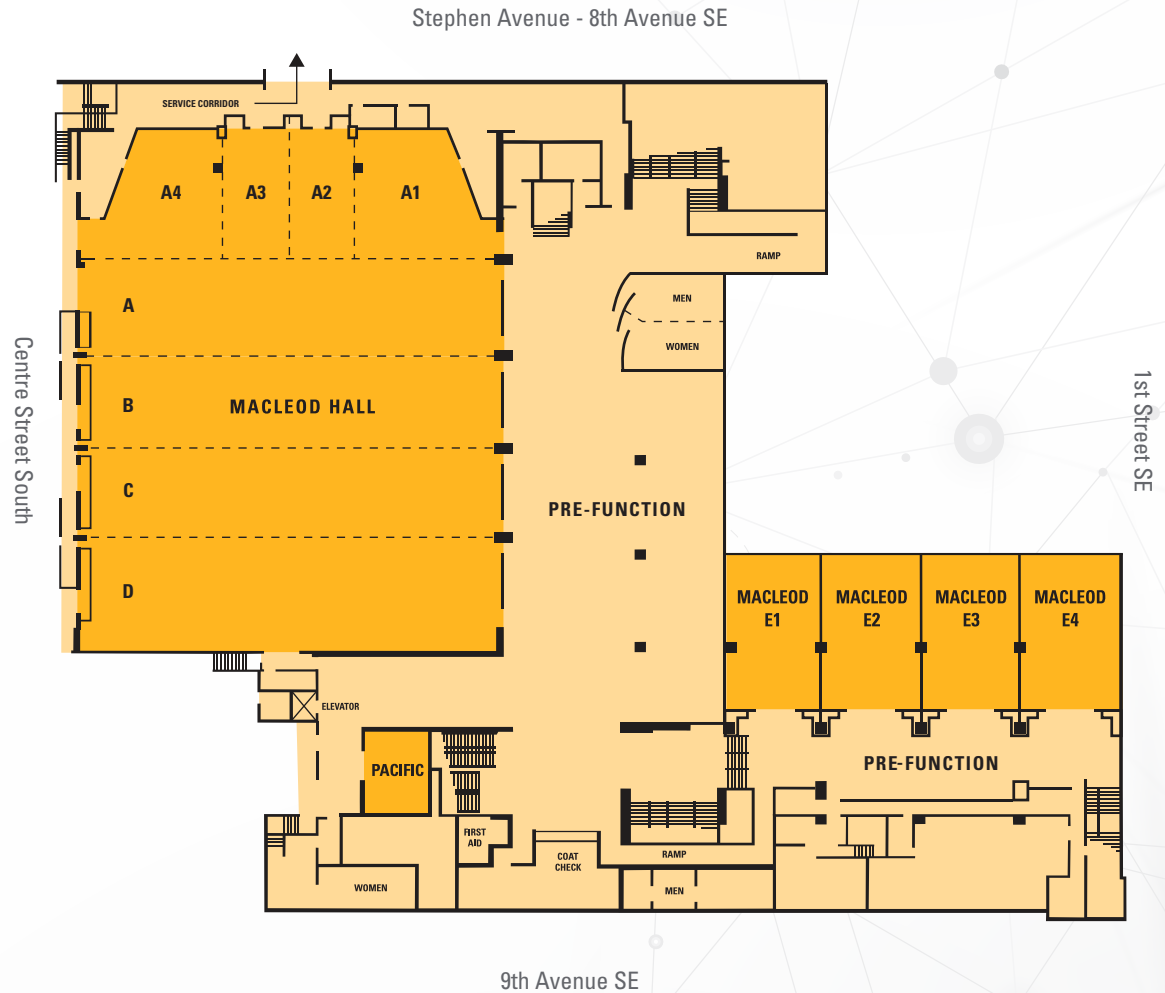



ROOM	CAPACITIES (MAXIMUM)			Meals*	Reception	Theatre Style	Class Room	Board Room	Hollow Square	U-Shape	Booth 10 × 10
	FEET	ft <sup>2</sup>	CEILING								
South Building											
Macleod Hall	126.0 × 156.8	19,757	11.9–20.3	1,600	1,786	2,100	1,134	-	-	-	96
*Macleod Hall A	126.0 × 65.9	8,303	20.3	630	440	650	450	-	-	-	36
Macleod Hall A1	37.7 × 26.5	999	11.9	80	87	100	54	32	38	30	-
Macleod Hall A2	37.7 × 20.0	754	11.9	50	58	60	36	26	34	30	-
Macleod Hall A3	37.7 × 20.0	754	11.9	50	58	60	36	26	34	30	-
Macleod Hall A4	37.7 × 25.0	943	11.9	80	87	100	54	32	38	30	-
Macleod Hall A5	126.0 × 28.2	3,553	20.3	-	-	-	-	-	-	-	-
Macleod Hall B	126.0 × 27.8	3,503	20.3	240	160	300	207	-	-	-	23
Macleod Hall C	126.0 × 27.8	3,503	20.3	240	160	300	207	-	-	-	23
Macleod Hall D	126.0 × 35.3	4,448	20.3	360	240	370	225	-	-	-	23
Macleod Hall Pre-function	62.0 × 108.6	6,733	10.0	-	512	-	-	-	-	-	-
Macleod Hall A1, 2	37.7 × 46.5	1,753	11.9	130	145	145	96	42	50	42	-
Macleod Hall A1, 2, 3	37.7 × 66.4	2,503	11.9	180	203	200	141	-	-	-	-
Macleod Hall A1, 2, 3, 4	37.7 × 91.4	3,446	11.9	270	296	290	192	-	-	-	-
Macleod Hall A2, 3	37.7 × 39.9	1,504	11.9	100	116	110	90	32	48	38	-
Macleod Hall A2, 3, 4	37.7 × 64.9	2,447	11.9	180	208	200	141	-	-	-	-
Macleod Hall A3, 4	37.7 × 44.9	1,693	11.9	130	151	145	96	42	50	42	-
*Macleod Hall A, B	126.0 × 93.7	11,806	11.9–20.3	870	872	1,100	714	-	-	-	57
*Macleod Hall A, B, C	126.0 × 121.5	15,309	11.9–20.3	1,120	1,142	1,550	860	-	-	-	78
Macleod Hall B, C	126.0 × 55.6	7,006	20.3	560	544	660	414	-	-	-	44
Macleod Hall B, C, D	126.0 × 90.9	11,453	20.3	920	890	1,100	690	-	-	-	63
Macleod Hall C, D	126.0 × 63.1	7,951	20.3	690	617	806	504	-	-	-	42
Pacific 6	17.1 × 24.3	416	-	20	29	25	12	14	18	14	-
Macleod Hall E1	47.0 × 31.3	1,471	12.5	100	115	120	60	32	38	34	-
Macleod Hall E2	47.0 × 29.3	1,377	12.5	80	107	100	54	32	38	34	-
Macleod Hall E3	47.0 × 29.3	1,377	12.5	80	107	100	54	32	38	34	-
Macleod Hall E4	47.0 × 29.3	1,377	12.5	80	107	100	54	32	38	34	-
Macleod E Pre-function	111.6 × 27.0	3,013	12.5	-	171	-	-	-	-	-	-

**Note:** Capacity numbers will decrease with the addition of audio visual equipment, head tables, staging, etc.

†Meals based on rounds × 10.

\*Macleod Hall A includes A1, A2, A3, A4.