

# Facility Guide



Calgary TELUS  
Convention Centre



## Welcome to the Calgary TELUS Convention Centre.

We believe that even small connections can inspire profound perspectives. Because when the right people and purposes align, routine events become something extraordinary.

# Let's get connected.

Welcome to Calgary—a welcoming, vibrant city connected to a world of possibilities. It's easy to get here—the Calgary International Airport is no more than a one-stop connection from any major destination worldwide. Once you've arrived, our world-class dining and entertainment, cultural experiences, and proximity to the stunning Rocky Mountains will make it even easier to stick around.

As Canada's fourth-largest city and a hub for business, innovation, and culture, Calgary offers delegates an unforgettable place to meet. Explore over 1,000 shops, restaurants, and entertainment venues in the downtown core—less than 20 minutes from the airport and all within walking distance from the Calgary TELUS Convention Centre.



## Your event, your way.

From small board meetings to international conferences, the Calgary TELUS Convention Centre is a canvas for your creativity. We know that no two events are ever the same. That's why we're built for flexibility—with versatile spaces and a masterful team of experts capable of bringing your vision to life.

The possibilities only grow once you set foot outside our doors—or take a step into the Plus 15 Skywalks connecting us to the surrounding buildings. Our location, woven into the fabric of a vibrant downtown core, puts you at the centre of all the dining, entertainment, arts, culture, shopping, and nightlife that Calgary offers, starting right here on the energetic Stephen Avenue. With more than 1,100 connected rooms across three partner hotels, you don't have to travel far to take it all in—but if you're feeling adventurous, you can easily hop on the CTrain, the City's light rail system, which runs next to our North Building, and explore the rest of the city.



# Our Neighbourhood

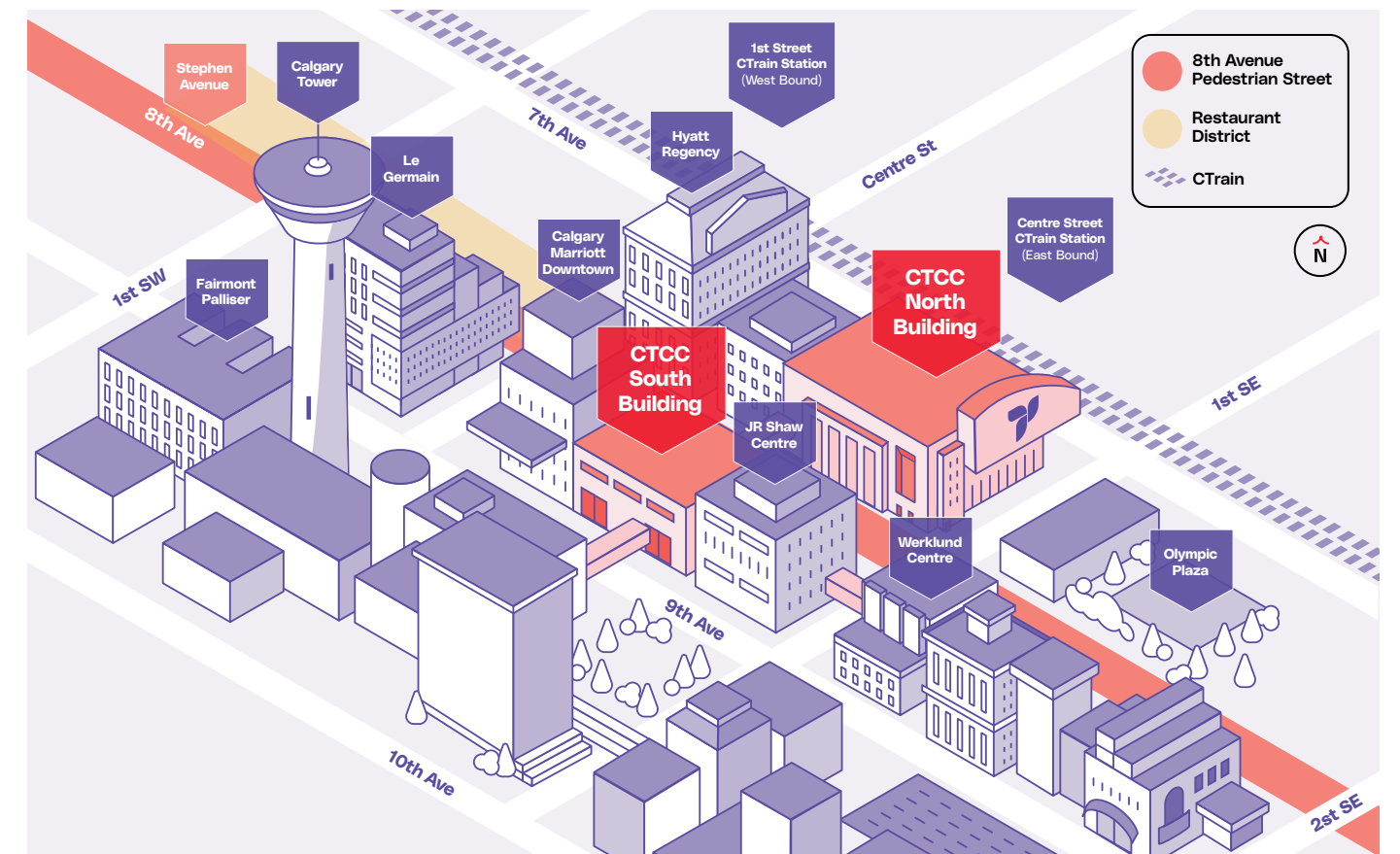

## Offsite Experiences

**OLYMPIC PLAZA**  
First created for the 1988 Winter Olympics medal ceremonies, this urban park is one of Calgary's most well-known gathering spaces. You'll often come across festivals and events at the plaza, and in the winter, it transforms into a public skating rink.

**JR SHAW CENTRE FOR ARTS & CULTURE (GLENBOW)**  
This museum is home to the largest public art collection in Western Canada. Guided by the belief that art is for everyone, the centre offers free general admission to its incredible exhibitions, displays, and installations.

**WERKLUND CENTRE**  
Western Canada's largest arts centre is home to six resident companies, including the award winning Calgary Philharmonic Orchestra. The Werklund Centre hosts a range of concerts, theatre productions, dance events, and more.

**CALGARY TOWER**  
This iconic building may no longer hold the title of the tallest in Calgary, but remains the most recognizable. Boasting 360-degree views of the city from the top observation deck and the opportunity to dine in a revolving restaurant more than 150 metres above ground level, the tower offers a unique perspective on the city.

## Dining

From fine dining to quick bites, you'll find what you're craving and more along Stephen Avenue, right outside our doors. With more than 100 dining options within walking distance from the CTCC, there's never a shortage of culinary experiences to discover.

Our Love Your Lanyard program turns your event lanyard into a passport to exclusive deals from partner restaurants and attractions throughout our downtown neighbourhood.

## Accommodations

**CALGARY MARRIOTT DOWNTOWN HOTEL**  
Experience refined comfort at the Calgary Marriott Downtown Hotel, conveniently connected to our South Building since the convention centre's inception. Beyond its breathtaking skyline views, this 388-room hotel boasts a convenient Starbucks for a pick-me-up before exploring the city's best shopping, culinary delights, and warm hospitality. At the end of the day, settle in at One18 Empire with a cocktail, craft beer, or choose from more than 300 whisk(e)ys, ryes, bourbons and scotches.

**HYATT REGENCY CALGARY**  
Stay where comfort gets classy. Standing tall and connected to our North Building, the 355-room Hyatt Regency is an elegant urban retreat. Enjoy a splash of relaxation at the pool, unwind at the spa, and dine at the highly rated Thomsons Kitchen & Bar. There's coffee in the room, but don't leave without sipping a rich and satisfying latte from Bakers Café.

**FAIRMONT PALLISER**  
Step into luxury at Calgary's iconic Fairmont Palliser. This historic hotel, beautifully appointed and admired, connects to our South Building via the Plus 15 Skywalk network. With 407 resplendent rooms, the Fairmont Palliser is your retreat for relaxation after an eventful day in Calgary's bustling downtown core.

**LE GERMAIN HOTEL CALGARY**  
Located just steps from the CTCC, Le Germain was designed with comfort, sustainability, and convenience in mind. Enjoy happy hour at Lounge Central 899, eat your fill at CHARCUT Roast House, or unwind from the day at RnR Wellness Spa—all just steps from any of Le Germain's 143 rooms.

# About the CTCC

OVER 122,000 SQ. FT.  
of meeting space

## 01 A Place of Possibilities

Here at the CTCC, we organize events that surpass every expectation, create a lasting impression on our guests, and illuminate a path towards a more energetic, inclusive, and responsible future. We are proud to work with our masterful in-house partners across show services, audio visual, food and beverage, and event design to create a one-of-a-kind experience for every event.

## 02 Sustainability

Our commitment to the environment goes beyond policy. It is a heartfelt promise to purposefully create a better world. Solar panels, reducing electrical consumption, low-flow water fixtures, extensive recycling and reduction programs, and renewable green power initiatives are just some of the ways we're creating a clean, breathable, eco-friendly centre for all to enjoy.

## 03 Collective Responsibility

We take pride in acting by principle, following both our consciences and the United Nations' Sustainability and Development Goals. We work to create a better world through our events, experiences, operations, and social initiatives. Everyone is welcome at the CTCC, and we're constantly working to live up to that commitment. We've partnered with Pedesting, an app that can help people with disabilities, tourists, and parents with strollers avoid barriers, such as stairs, and find accessible routes to their destinations.

## 04 Indigenous Relations

The CTCC is located on Treaty 7 lands, inhabited by the Blackfoot people since time immemorial, and other Indigenous nations such as the Stoney Nakoda Nation, the Tsuut'ina, and the Métis people of Alberta Region 5 & 6. In the spirit of Truth and Reconciliation, we regularly engage in meaningful dialogue with elders, knowledge keepers, and Indigenous and Métis peoples in the area. We are proud to provide Indigenous programming for your event, helping enhance your delegate experience and create a lasting, meaningful connection with those who have been protecting the lands, waters, and ecosystem of Mohkinstsis.

## 05 Food & Beverage

Let us take care of your taste buds with a culinary experience like no other, courtesy of our exclusive partnership with the Calgary Marriott Downtown Hotel's award-winning team. With customizable menus that offer an array of delectables, each meal is an unforgettable moment.

## 06 Easy Access

Arriving by car? We've got you covered. Our central location offers ample parking, including over 400 covered spaces in the parkade beneath our North Building, including electric vehicle stations.

For event setup and takedown, our North and South Buildings both offer easy-to-find loading docks, each with unique incline heights and capacities. To make your setup process as smooth as your event, our Dock Master is at your service.

## 07 Technology

Sophisticated tech solutions at the CTCC are only ever a tap or click away. Our dedicated text-for-service line allows you to connect immediately with our in-house Client Services team throughout your event. Our shared high-speed internet option provides fast and reliable access, with an option for our premium dedicated high-speed for more intricate needs. Custom WI-FI networks are available and are accessible across the facility. We also offer a wide range of rental options—from Windows-based desktop computers to easy-to-use laptops, hubs, routers, and switches. We work closely with our in-house partners to deliver all audio visual services and equipment.



# North Building

# South Building

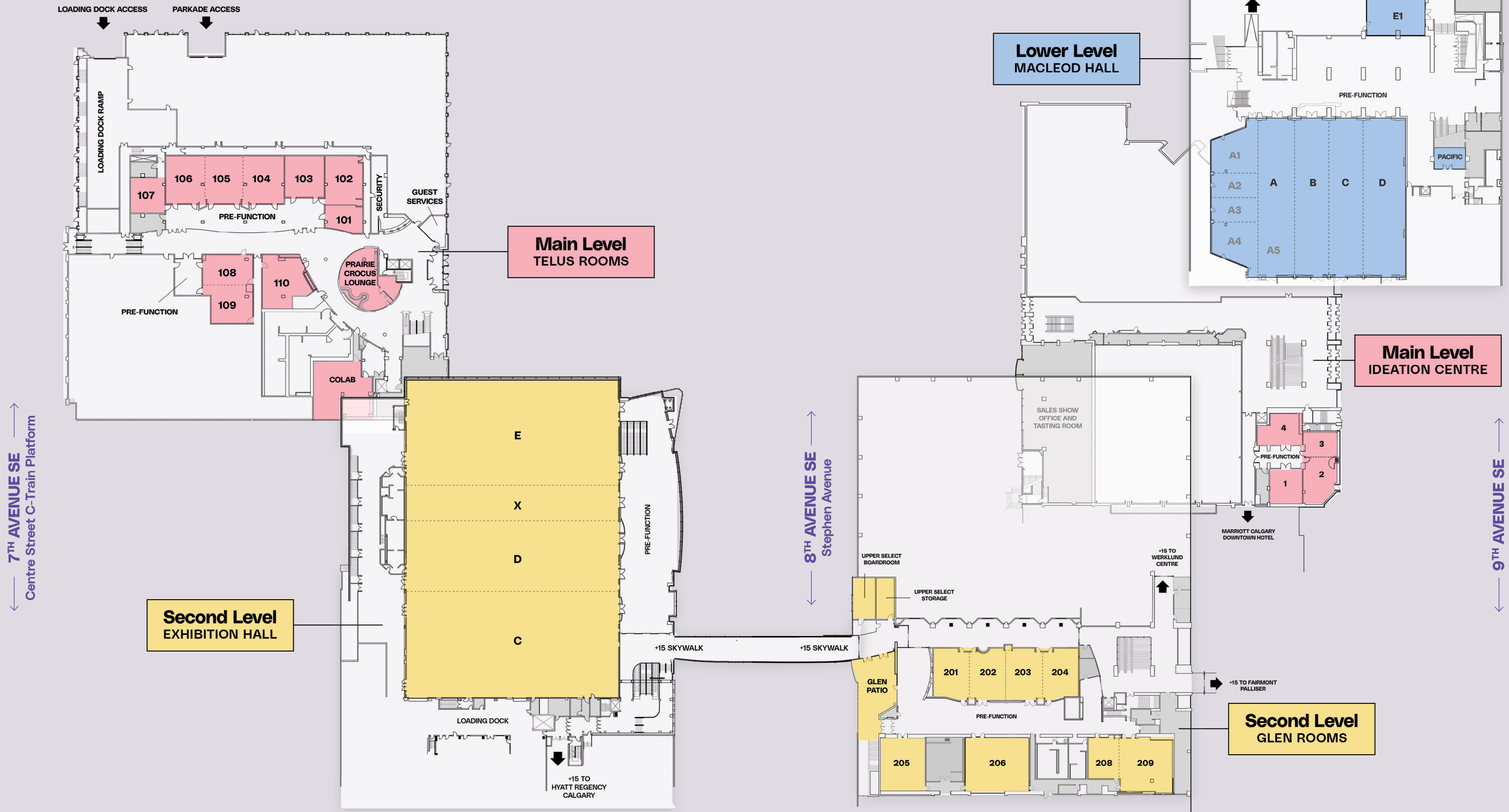



# Exhibition Hall

**CAPACITY**  
Up to 3,500 guests, or 250 tradeshow booths\*

Room	Feet	ft <sup>2</sup>	Meters	m <sup>2</sup>	Ceiling Height (ft.)	Rounds of 12	Rounds of 10	Reception	Theatre	Classroom	Booths 10x10
Exhibition Hall	177.2 x 265.5	47,047	54.0 x 80.9	4,370.8	29.9	3,432	2,860	4,725	4,725	3,366	254
Exhibition Hall C	177.2 x 89.4	15,845	54.0 x 27.2	1,472.0	29.9	1,092	980	1,425	1,425	1,056	88
Exhibition Hall D	177.2 x 59.3	10,508	54.0 x 18.1	976.2	29.9	624	560	946	946	693	61
Exhibition Hall E	177.2 x 87.7	15,540	54.0 x 26.7	1,443.7	29.9	1,092	980	1,425	1,425	990	90
Exhibition Hall C, D	177.2 x 148.7	26,350	54.0 x 45.3	2,448.0	29.9	1,872	1,560	2,625	2,625	1,848	140
Exhibition Hall C, D, X	177.2 x 177.8	31,506	54.0 x 54.2	2,927.0	29.9	2,184	1,820	3,225	3,225	2,178	169
Exhibition Hall D, X	177.2 x 88.4	15,664	54.0 x 26.9	1,455.2	29.9	1,092	980	1,425	1,425	1,056	90
Exhibition Hall D, X, E	177.2 x 176.1	31,205	54.0 x 53.7	2,899.0	29.9	2,184	1,820	3,150	3,150	2,178	173
Exhibition Hall X, E	177.2 x 116.8	20,697	54.0 x 35.6	1,922.8	29.9	1,404	1,170	2,100	2,100	1,452	117
Exhibition Hall Pre-Function	193.1 x 43.0	8,323	58.4 x 13.1	773.2	22.0	396	330	550	550	339	21

\* Note that capacity numbers will decrease with the addition of audiovisual equipment, head tables, staging and food and beverage service areas.

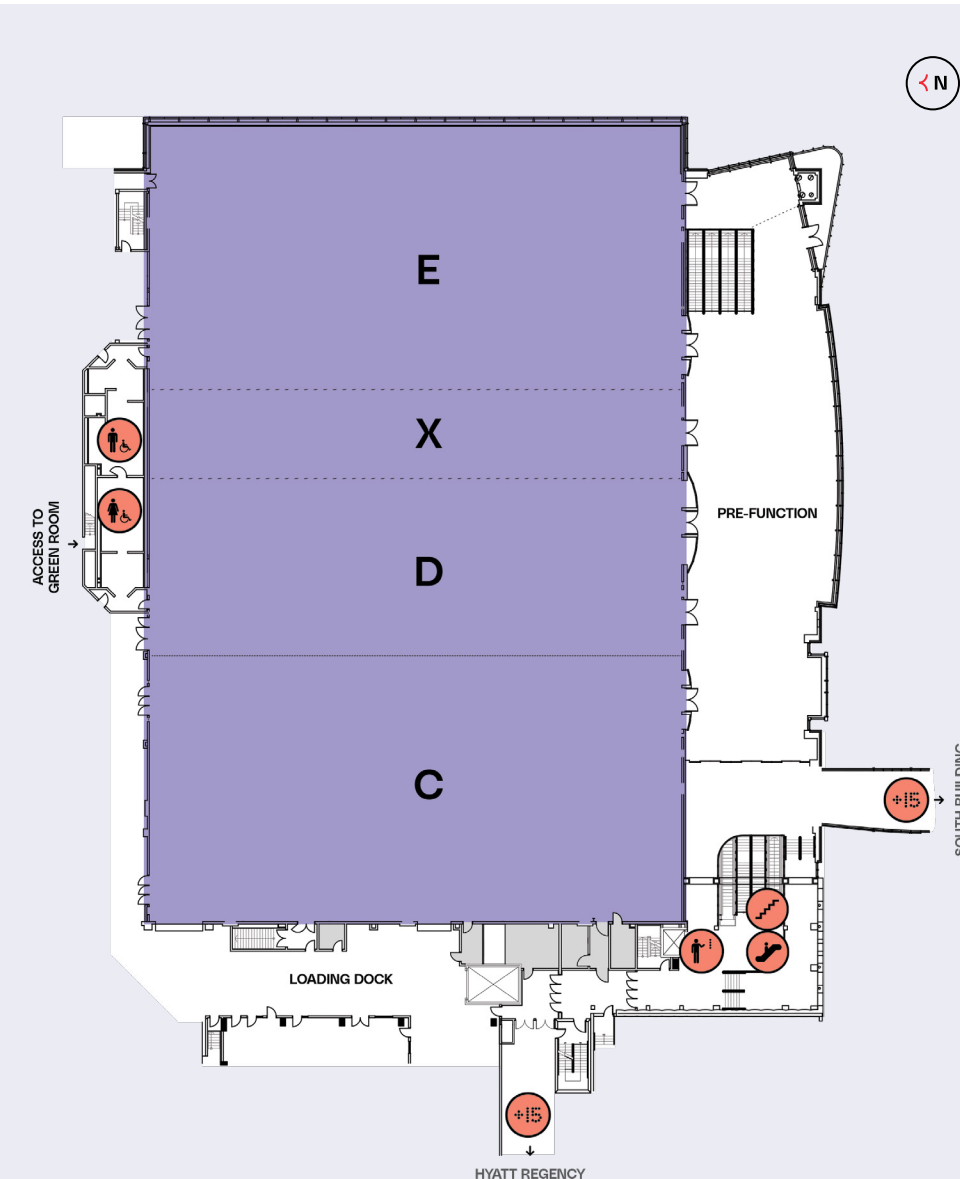

## NORTH BUILDING | SECOND LEVEL

- + Over 47,000 square feet of space divisible into three fully functional, standalone halls
- + Floor to ceiling windows along the east wall and the pre-function area provide ample light and views of downtown Calgary
- + A network of overhead rigging points provide near-limitless possibilities for staging, lighting, and design
- + Accessible from the Plus 15 Skywalk network and the Hyatt Regency Hotel
- + Direct access to the north loading dock



Additional Information

+15 Plus 15 Skywalk
Washroom
Stairs
Escalator
Elevator
--- Modular Wall



# TELUS Rooms

CAPACITY  
10-245 guests\*

Room	Feet	ft <sup>2</sup>	Meters	m <sup>2</sup>	Ceiling Height (ft.)	Rounds of 10	Rounds of 8	Reception	Theatre	Classroom	Boardroom	Hollow Square	U-Shape	Booths 10x10
TELUS 101	27.5 x 16.3	448	8.4 x 5.0	41.6	10.2	30	24	40	40	24	28	18	21	1
TELUS 102	27.5 x 35.4	974	8.4 x 10.8	90.5	10.2	60	48	88	88	54	22	30	27	5
TELUS 103	30.0 x 28.7	861	9.1 x 8.7	80.0	10.0	50	40	84	84	60	28	30	27	4
TELUS 104	34.8 x 29.8	1,037	10.6 x 9.1	96.3	10.2	60	48	96	96	60	28	30	27	5
TELUS 105	34.8 x 27.4	954	10.6 x 8.4	88.6	10.2	60	48	88	88	54	28	30	27	5
TELUS 106	34.8 x 28.5	992	10.6 x 8.7	92.2	10.2	60	48	88	88	54	28	30	27	5
TELUS 107	25.0 x 26.0	650	7.6 x 7.9	60.4	7.3	40	32	54	54	42	22	24	21	6
TELUS 108	34.6 x 22.2	768	10.5 x 6.8	71.3	9.3	50	40	70	70	36	22	24	21	6
TELUS 109	30.4 x 27.6	539	9.3 x 8.4	50.1	9.6	50	40	68	68	48	22	24	21	6
TELUS 110 (Coat Check)	29.3 x 39.5	1,157	8.9 x 12.0	107.5	10.1	60	48	96	96	42	28	24	21	4
The Colab	43.2 x 40.3	1,741	13.2 x 12.3	161.7	8.3	100	80	117	117	78	34	20	33	5
TELUS 101, 102	27.5 x 51.7	1,422	8.4 x 15.8	132.1	10.2	100	80	143	143	84	46	48	45	6
TELUS 104, 105	34.8 x 57.2	1,991	10.6 x 17.4	185.0	10.2	140	112	200	200	114	46	54	54	10
TELUS 104, 105, 106	34.8 x 87.5	2,982	10.6 x 26.1	277.0	10.2	220	176	312	312	186	76	78	75	15
TELUS 105, 106	34.8 x 55.9	1,945	10.6 x 17.0	180.7	10.2	140	112	200	200	120	46	54	54	10
TELUS 108, 109	34.6 x 49.8	1,723	10.5 x 15.2	160.1	9.3	110	88	138	138	90	46	48	45	5
TELUS Pre-Function (101 - 107)	20.9 x 116.6	2,437	6.4 x 35.5	226.4	11.0	70	56	129	129	-	-	-	-	6
TELUS Pre-Function (108 - 109)	25.9 x 19.0	492	7.9 x 5.8	45.7	11.2	20	16	34	34	-	-	-	-	1
Prairie Crocus Lounge	45.0 x 26.7	1,210	13.9 x 8.1	112.4	10.2	-	-	60	-	-	-	-	-	-

\* Note that capacity numbers will decrease with the addition of audiovisual equipment, head tables, staging and food and beverage service areas.

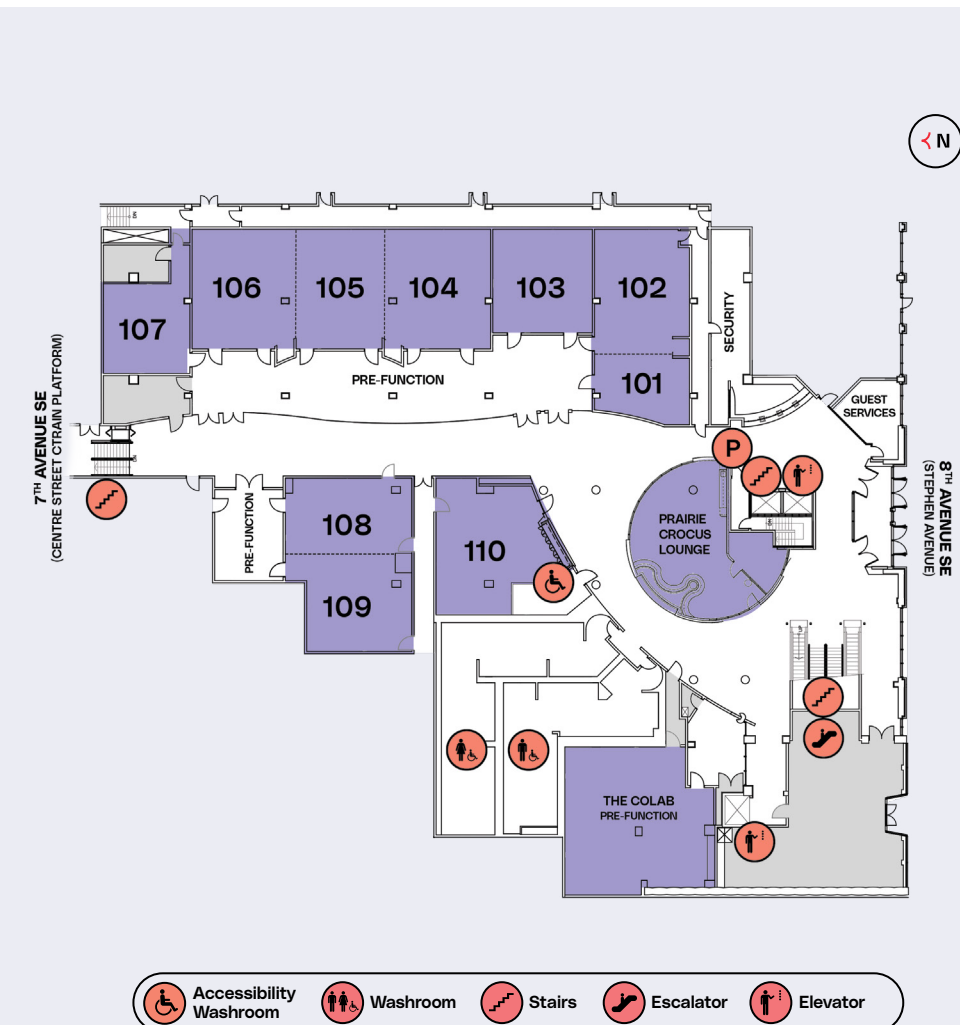

## NORTH BUILDING | MAIN LEVEL

- + TELUS rooms are adjacent to the Colab space and the Prairie Crocus Lounge, unique spaces that can foster innovative thinking and spark your next big idea
- + Main-floor location provides easy access to the parkade and Stephen Avenue
- + Spacious pre-function areas are enclosed with glass for noise reduction
- + Flexible wall placement allows for different configurations and breakout rooms as needed

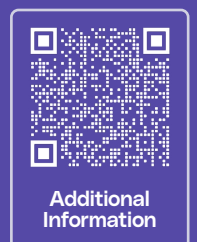

Accessibility  
 Washroom  
 Stairs  
 Escalator  
 Elevator



# Macleod Hall

CAPACITY  
30-2,100 guests\*

Room	Feet	ft <sup>2</sup>	Meters	m <sup>2</sup>	Ceiling Height (ft.)	Rounds of 10	Rounds of 8	Reception	Theatre	Classroom	Boardroom	Hollow Square	U-Shape	Booths 10x10
Macleod Hall	126.0 x 156.8	19,757	38.4 x 47.8	1,835.5	11.9-20.3	1,360	1,088	2,084	2,084	1,185	-	-	-	98
Macleod Hall A	126.0 x 65.9	8,303	38.4 x 20.1	771.4	20.3	560	448	745	745	447	-	-	-	36
Macleod Hall B	126.0 x 27.8	3,503	38.4 x 8.5	325.4	20.3	230	184	310	310	225	-	-	-	22
Macleod Hall C	126.0 x 27.8	3,503	38.4 x 8.5	325.4	20.3	230	184	310	310	225	-	-	-	22
Macleod Hall D	126.0 x 35.3	4,448	38.4 x 10.8	413.2	20.3	330	264	406	406	300	-	-	-	22
Macleod Hall A1	37.7 x 26.5	999	11.5 x 8.1	92.8	11.9	80	64	100	100	72	34	36	30	4
Macleod Hall A2	37.7 x 20.0	754	11.5 x 6.1	70	11.9	60	48	64	64	42	28	30	27	3
Macleod Hall A3	37.7 x 20.0	754	11.5 x 6.1	70	11.9	60	48	64	64	42	28	30	27	3
Macleod Hall A4	37.7 x 25.0	943	11.5 x 7.6	87.6	11.9	80	64	100	100	72	34	36	30	4
Macleod Hall A5	126.0 x 28.2	3,553	38.4 x 8.6	330.1	20.3	220	176	310	310	225	-	-	-	22
Macleod Hall A1, A2	37.7 x 45.6	1,753	11.5 x 14.2	162.9	11.9	140	112	177	177	114	46	48	48	8
Macleod Hall A1, A2, A3	37.7 x 66.4	2,503	11.5 x 20.2	232.5	11.9	200	160	249	249	180	64	66	66	9
Macleod Hall A1, A2, A3, A4	37.7 x 91.4	3,446	11.5 x 27.9	320.1	11.9	280	224	354	354	255	94	102	96	17
Macleod Hall A2, A3	37.7 x 39.9	1,504	11.5 x 12.2	139.7	11.9	120	96	144	144	105	34	48	36	6
Macleod Hall A2, A3, A4	37.7 x 64.9	2,447	11.5 x 19.8	227.3	11.9	200	160	249	249	180	64	66	66	9
Macleod Hall A3, A4	37.7 x 44.9	1,693	11.5 x 13.7	157.3	11.9	140	112	174	174	114	46	48	48	8
Macleod Hall A, B	126.0 x 96.7	11,806	38.4 x 28.6	1,096.8	11.9-20.3	800	640	1,156	1,156	696	-	-	-	57
Macleod Hall A, B, C	126.0 x 121.5	15,309	38.4 x 37.0	1,422.3	11.9-20.3	1130	904	1,492	1,492	906	-	-	-	78
Macleod Hall B, C	126.0 x 55.6	7,006	38.4 x 16.9	650.9	20.3	550	440	784	784	420	-	-	-	44
Macleod Hall B, C, D	126.0 x 90.9	11,453	38.4 x 27.7	1,064.0	20.3	880	704	1,176	1,176	714	-	-	-	64
Macleod Hall C, D	126.0 x 63.1	7,951	38.4 x 19.2	738.7	20.3	660	528	840	840	504	-	-	-	43
Pacific	17.1 x 24.3	416	5.2 x 7.4	38.6	8.6	30	24	30	30	30	22	24	21	-
Macleod Hall E1	47.0 x 31.3	1,471	14.3 x 9.5	136.7	12.5	100	80	138	138	81	40	42	42	6
Macleod Hall E2	47.0 x 29.3	1,377	14.3 x 8.9	127.9	12.5	100	80	138	138	81	40	42	42	6
Macleod Hall E3	47.0 x 29.3	1,377	14.3 x 8.9	127.9	12.5	100	80	138	138	81	40	42	42	6
Macleod Hall E4	47.0 x 29.3	1,377	14.3 x 8.9	127.9	12.5	100	80	138	138	81	40	42	42	6
Macleod Hall Pre-Function	62.0 x 108.6	6,733	18.9 x 33.1	625.5	10.0	640	512	520	-	-	-	-	-	29
Macleod Hall E Pre-Function	111.6 x 27.0	3,013	34.0 x 8.2	279.9	12.5	140	112	171	-	-	-	-	-	5

\*Note that capacity numbers will decrease with the addition of audiovisual equipment, head tables, staging and food and beverage service areas.

## SOUTH BUILDING | LOWER LEVEL

- + Nearly 20,000 square feet of space to set up in the style most suited to your event
- + Can serve as a plenary hall, banquet hall, ballroom and several breakout rooms all in one
- + Arrange the movable walls to create a single space, or up to seven small rooms with a large pre-function area
- + Pre-function space is equally versatile and can be used for registration, buffet service meals, refreshment breaks, receptions, or a welcoming bar area

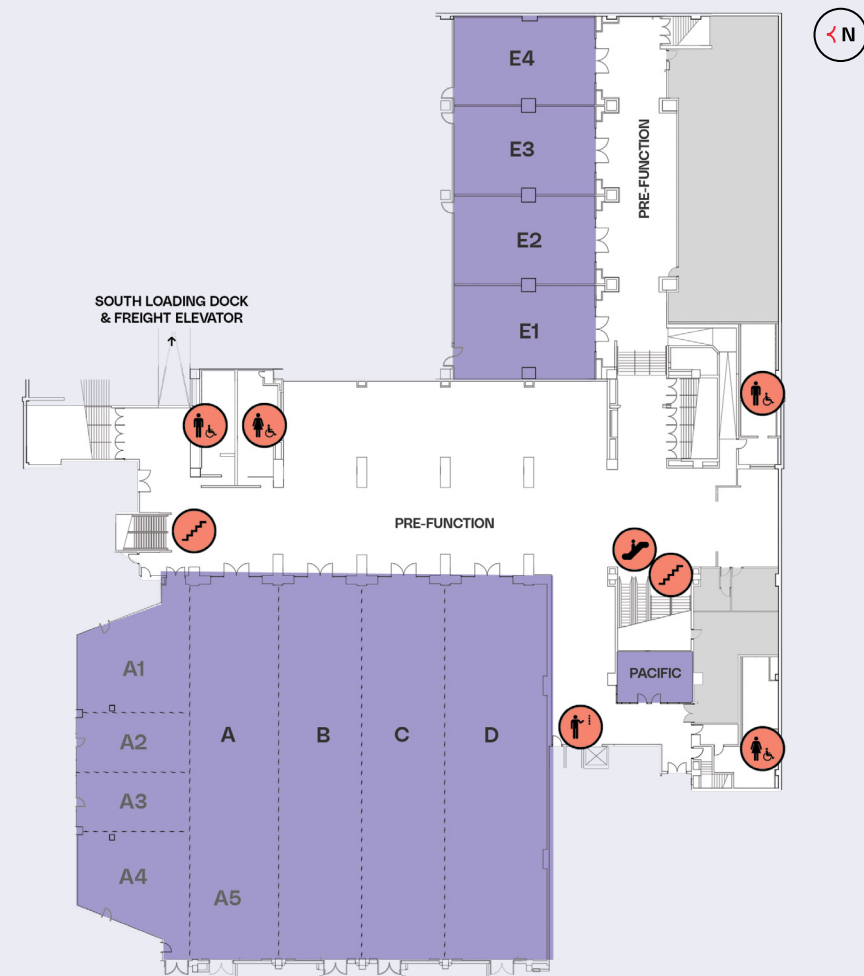

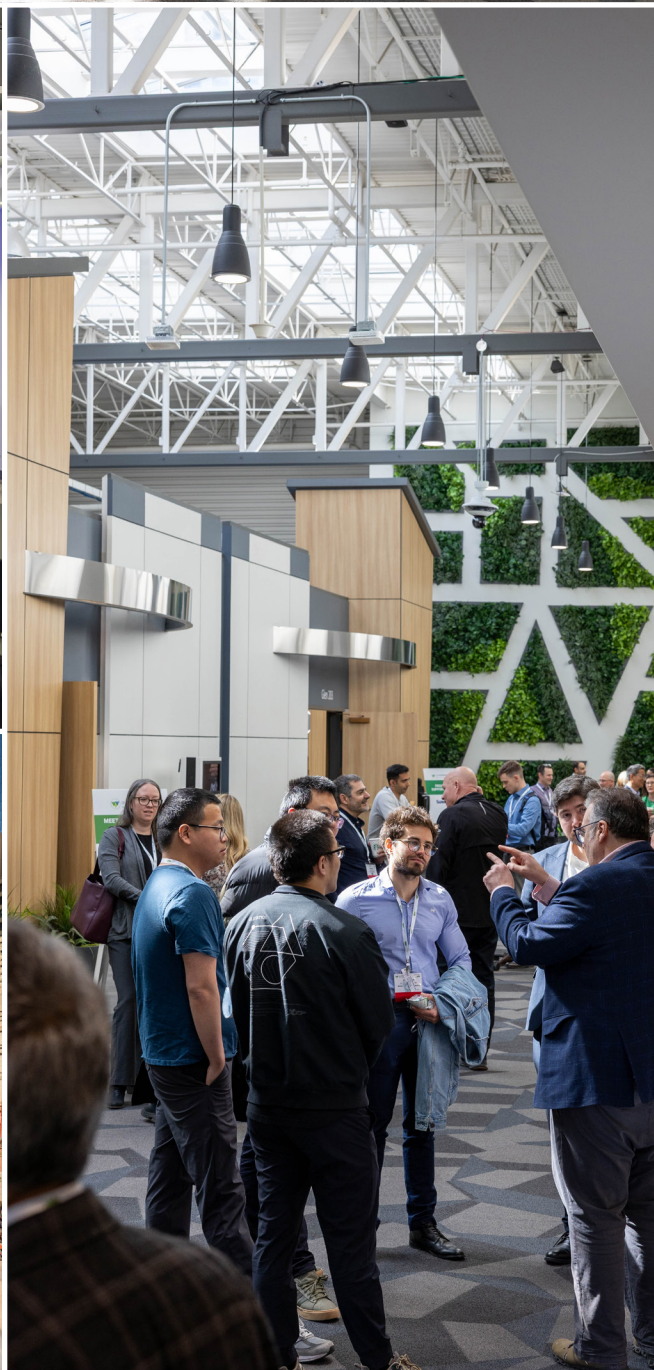

# Glen Rooms

**CAPACITY**  
20-350+ guests\*

Room	Feet	ft <sup>2</sup>	Meters	m <sup>2</sup>	Ceiling Height (ft.)	Rounds of 10	Rounds of 8	Reception	Theatre	Classroom	Boardroom	Hollow Square	U-Shape	Booths 10x10
Glen 201	37.3 x 27.3	1,018	11.4 x 8.3	94.6	9.9	60	48	93	93	54	28	36	30	5
Glen 202	38.0 x 27.6	1,049	11.6 x 8.4	97.5	9.9	60	48	94	94	54	28	36	30	5
Glen 203	38.2 x 27.7	1,058	11.6 x 8.5	98.3	9.9	60	48	97	97	54	28	36	30	5
Glen 204	36.7 x 27.3	1,002	11.2x8.3	93.1	9.9	60	48	94	94	54	28	36	30	5
Glen 205	40.3 x 34.3	1,382	12.3 x 10.5	128.4	8.9	150	120	135	135	84	34	36	36	7
Glen 206	41.1 x 48.6	1,997	12.5 x 14.8	185.5	8.9	150	120	204	204	123	40	48	45	9
Glen 208	31.5 x 23.4	737	9.6 x 7.1	68.5	8.9	50	40	55	55	45	22	24	27	2
Glen 209	38.4 x 39.8	1,528	11.7 x 12.1	142.0	8.9	90	72	132	132	69	34	42	36	6
Upper Select Boardroom	32.0 x 17.8	570	9.8 x 5.4	53.0	8.7	-	-	-	-	-	-	-	-	-
Upper Select Storage	32.0 x 13.9	445	9.8 x 4.2	41.3	8.7	-	-	-	-	-	-	-	-	-
Glen 201, 202	37.3 x 54.9	2,048	11.4 x 16.7	190.3	9.9	150	120	182	182	108	46	54	48	10
Glen 201, 202, 203	37.3 x 82.6	3,081	11.4 x 25.2	286.2	9.9	240	192	195	195	162	70	78	78	15
Glen 201, 202, 203, 204	37.3 x 109.9	4,099	11.4 x 33.5	380.8	9.9	300	240	390	390	216	100	102	102	20
Glen 202, 203	38.0 x 55.3	2,101	11.6 x 16.9	195.2	9.9	150	120	195	195	108	46	54	48	10
Glen 202, 203, 204	38.0 x 82.6	3,139	11.6 x 25.2	291.6	9.9	240	192	286	286	162	70	78	78	15
Glen 203, 204	38.2 x 55.0	2,101	11.6 x 16.8	195.2	9.9	150	120	195	195	111	46	54	48	10
Glen 208, 209	31.5 x 63.2	1,991	9.6 x 19.3	185.0	8.9	140	112	210	210	114	58	66	54	8
Glen Pre-Function	25.0 x 125.0	3,125	7.6 x 38.1	290.3	26.8	150	120	240	240	-	-	-	-	12
Glen Patio	30.0 x 63.0	1,992	9.1 x 19.2	185.1	-	-	-	154	-	-	-	-	-	-

\* Note that capacity numbers will decrease with the addition of audiovisual equipment, head tables, staging and food and beverage service areas.



Ⓢ Plus 15 Skywalk 
 ♿ Washroom 
 🪜 Stairs 
 🚶 Escalator 
 🚪 Elevator 
 --- Modular Wall

## SOUTH BUILDING | SECOND LEVEL

- + Approximately 12,000 square feet of space, accommodating groups of 20-350+
- + Natural light from the skylights gives the space a calm and comfortable atmosphere
- + Adjacent outdoor patio for use in the warmer months
- + Connected by the Plus 15 Skywalks to the North Building, as well as the Calgary Tower and Fairmont Palliser Hotel
- + Includes the Upper Select Boardroom, a fully networked executive corner office, with a great view of Stephen Avenue

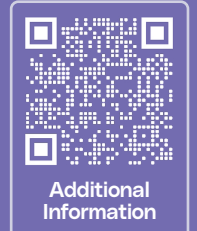



# Ideation Centre

**CAPACITY**  
Up to 160 guests\*

Room	Feet	ft <sup>2</sup>	Meters	m <sup>2</sup>	Ceiling Height (ft.)	Rounds of 10	Rounds of 8	Reception	Theatre	Classroom	Boardroom	Hollow Square	U-Shape	Booths 10x10
Ideation 1	28.1 x 26.0	731	8.6 x 7.9	67.9	11.8	40	32	60	60	45	22	24	21	4
Ideation 2	27.3 x 37.8	1,032	8.3 x 11.5	62.9	11.8	50	40	72	72	39	28	30	27	3
Ideation 3	27.3 x 19.5	532	8.3 x 5.9	49.5	11.8	30	12	45	45	27	22	18	15	2
Ideation 4	25.1 x 25.5	640	7.7 x 7.8	59.5	9.4	50	40	75	75	42	28	24	21	3
Ideation 2, 3	37.3 x 57.3	1,564	8.3 x 17.5	145.3	11.8	90	72	135	135	66	46	48	45	5

\* Note that capacity numbers will decrease with the addition of audiovisual equipment, head tables, staging and food and beverage service areas.

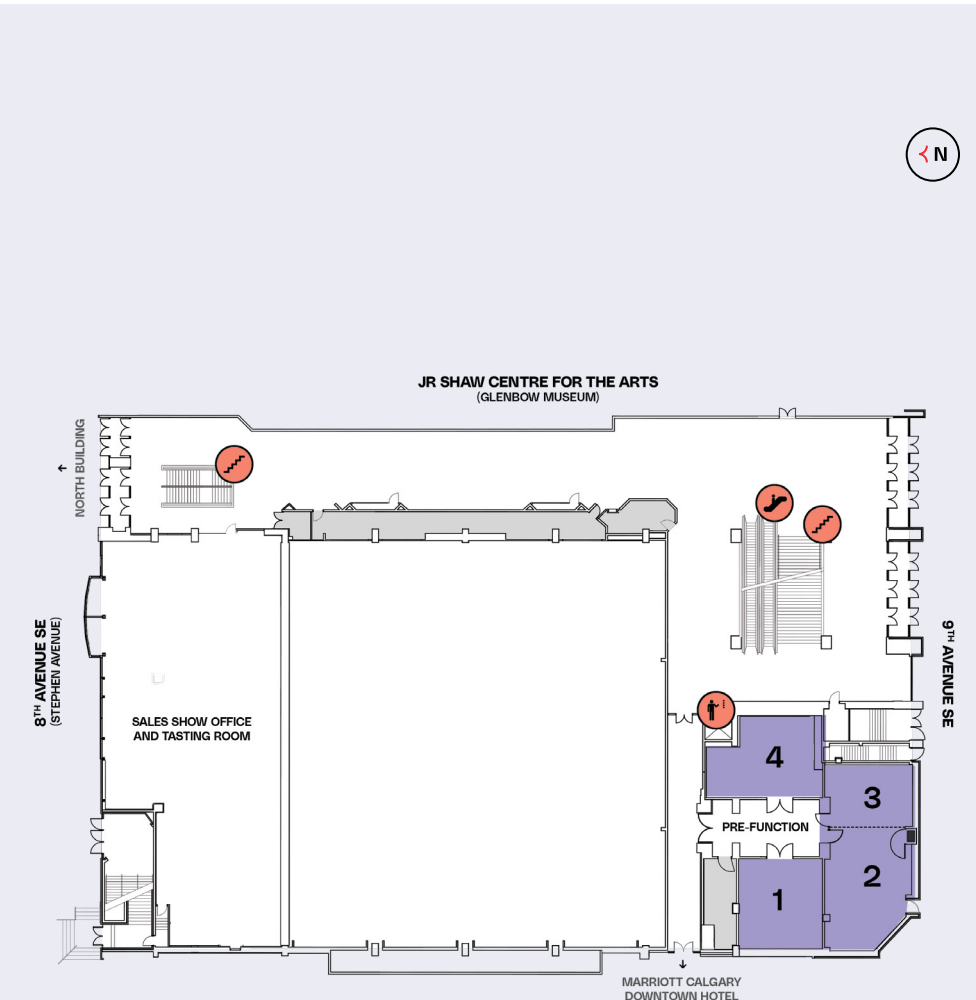

## SOUTH BUILDING | MAIN LEVEL

- + Bright spaces with furnishings purposely chosen to encourage easier collaboration
- + Four rooms in total with an adjoining central pre-function area
- + Main floor location provides easy access to Stephen Avenue and the Calgary Marriott Downtown Hotel
- + Perfectly suited for board meetings, workshops, and simultaneous brainstorming sessions
- + Approximately 3,000 square feet of space, accommodating groups of 60-135

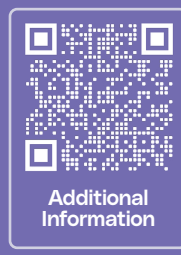

Washroom
 Stairs
 Escalator
 Elevator



### Land Acknowledgement

We humbly acknowledge that the Calgary TELUS Convention Centre is situated on the ancestral Treaty 7 lands of the Blackfoot Confederacy. As a venue that hosts live events and facilitates connections promoting the convergence of ideas which may never have existed, we take inspiration from Wicispa, Guts'ists'l and Mohkinstsis, the confluence of the Bow and the Elbow rivers. We do so by acknowledging these lands are more than just spaces; they are gathering places, deeply interwoven in the traditional Indigenous stories, songs, languages, ceremonies, and lifeways that must be honoured and protected.

## **Calgary TELUS Convention Centre**

w: [calgary-convention.com](http://calgary-convention.com)

📷 [ctcc\\_calgary](#)

### **Guest Services Desk**

North Building – Main Entrance  
136 8th Avenue SE  
Calgary, Alberta, Canada  
T2G 0K6

### **Loading Dock**

705 1st Street SE  
Calgary, Alberta, Canada  
T2G 2G9

### **Mailing Address**

120 9th Avenue SE  
Calgary, Alberta, Canada  
T2G 0P3